

DO NOT SCALE
IF IN DOUBT ASK

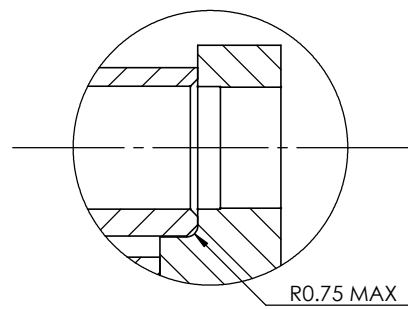

FLYWHEEL SPIGOT
DETAIL C
SCALE 2 : 1

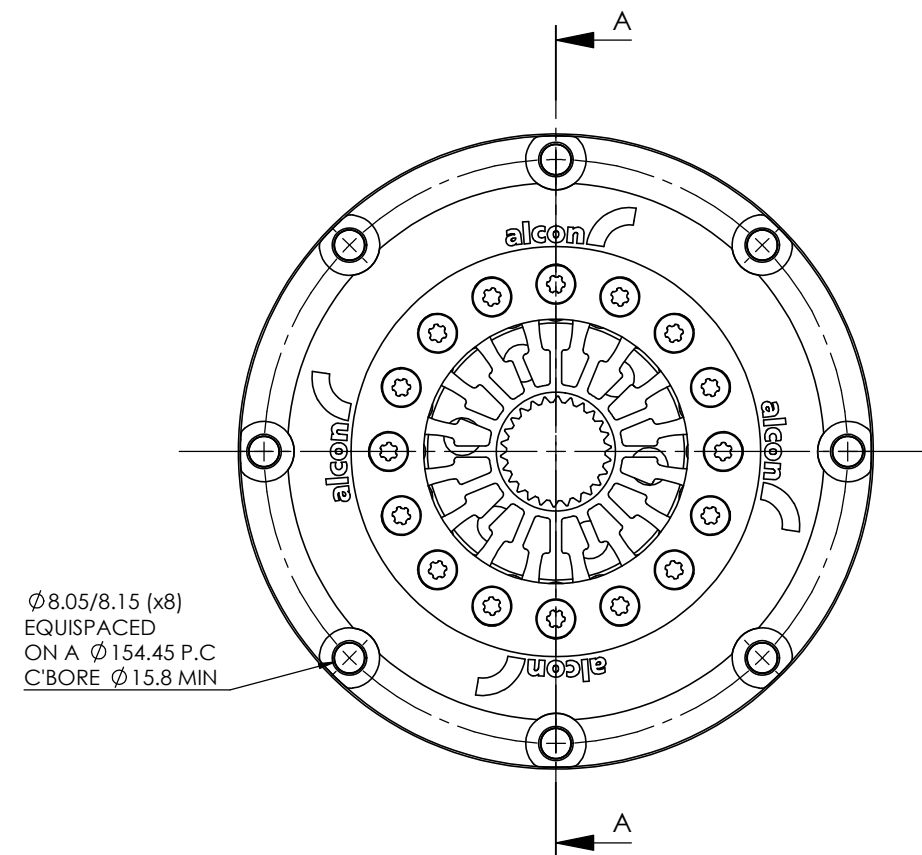
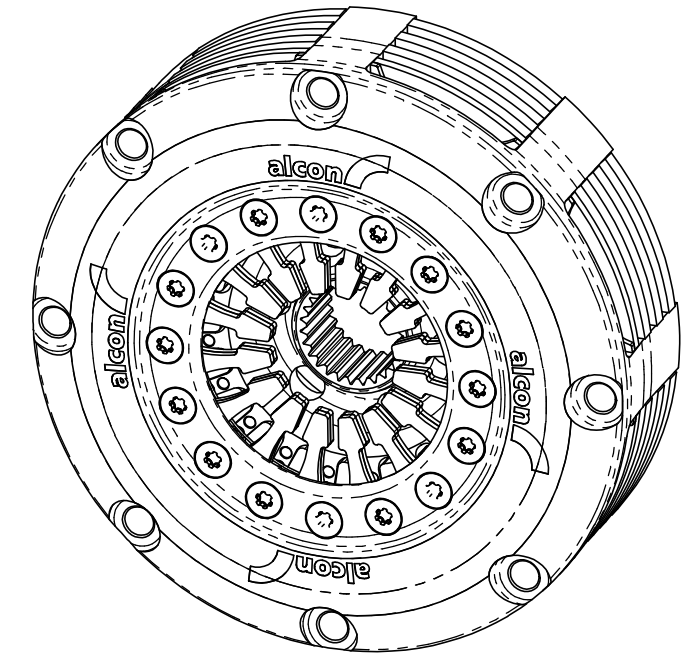

Ø8.05/8.15 (x8)
EQUISPACED
ON A Ø154.45 P.C
C'BORE Ø15.8 MIN

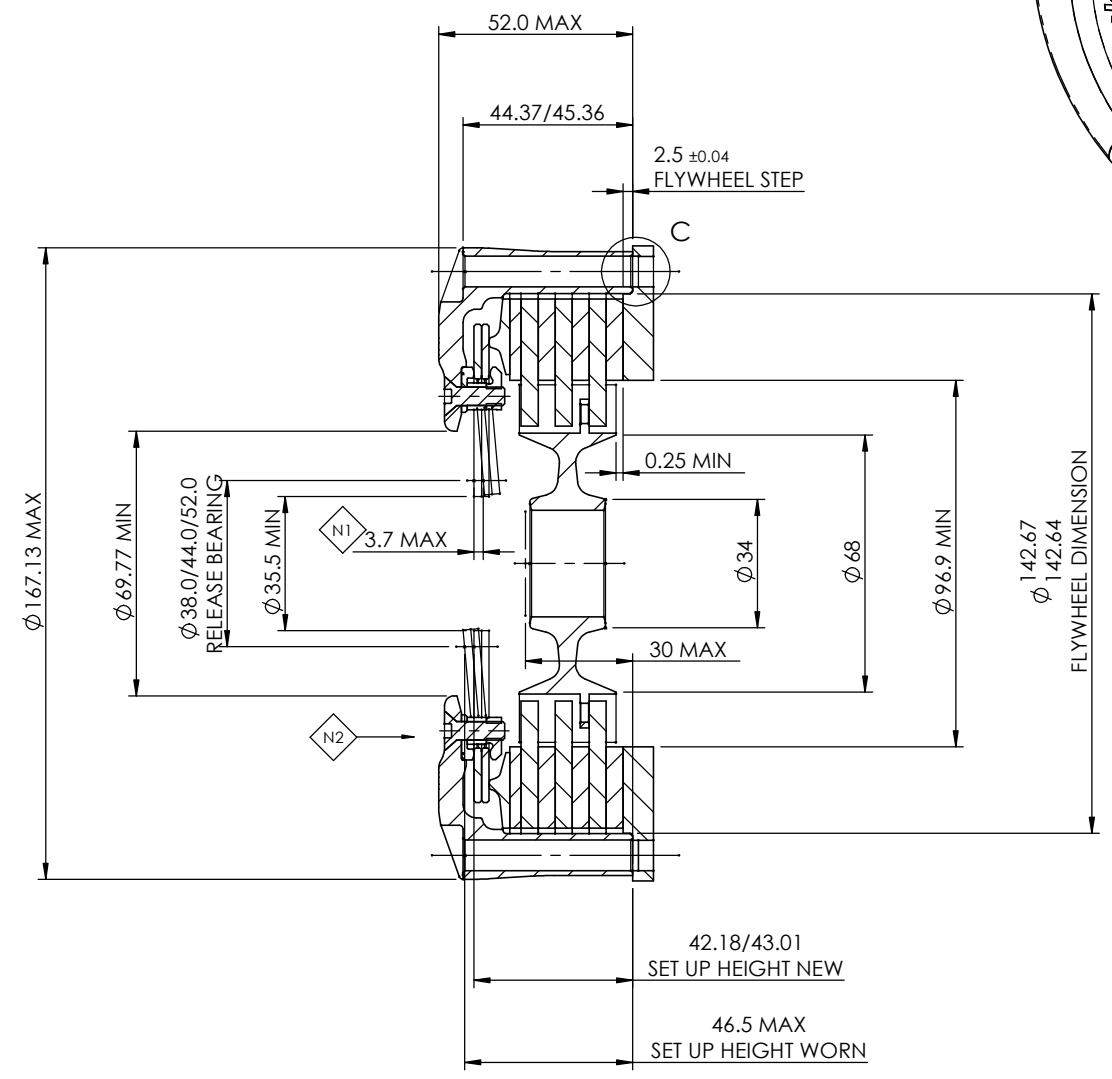

SECTION A-A
SCALE 1 : 2

NOTES:
N1 RELEASE TRAVEL
TO BE LIMITED BY EXTERNAL STOP.
N2 DIRECTION OF RELEASE TRAVEL.

CLUTCH ASSEMBLY PART NUMBER	SPRING IDENTITY	RELEASE RATIO	RELEASE LOAD (@ TRAVEL)			RECOMMENDED MAX DYNAMIC TORQUE CAPACITY	EST. ASSEMBLY MASS (INCLUDING HUB)	EST. ASSEMBLY INERTIA (INCLUDING HUB)	EST. DRIVEN PLATES AND HUB INERTIA
			38mm BEARING	44mm BEARING	52mm BEARING				
KKC1403HDGSD01	DOUBLE GREY	HIGH	2.9KN	3.2KN	3.5KN	840Nm (619 lb.ft)	2.11Kg	0.00683 Kgm²	0.00128 Kgm²
TIGHTENING TORQUE OF CLUTCH MOUNTING BOLTS = 22Nm									
MAXIMUM WEAR IN 0.75mm. AFTER THIS AMOUNT OF WEAR, NEXT COMPENSATING PRESSURE PLATE "SHIM" MUST BE FITTED.									
MAXIMUM WEAR OF CARBON/CARBON STACK = 4.00mm									

A FIRST ISSUE.		Change		ADS 18.08.11	AS 19.8.11
Issue	Change	LOC	DRN BY / Date	CHK BY / DATE	APP BY / Date
DRAWN IN SOLIDWORKS	SCALE: 1:2	DESIGN BY: ADS	DATE: 18.08.11	ALCON COMPONENTS LIMITED APOLLO TAMWORTH STAFFORDSHIRE B79 7TN TEL: +44(0)1827 72700	
REMOVE ALL SHARP EDGES, BURRS AND SWarf	MATERIAL: ---	CHK'D BY: AS	DATE: 19.08.11	alicon	
TOLERANCES UNLESS STATED	HEAT TREATMENT / HARDENING: ---	DATE: 19.08.11	DATE: 19.08.11	PART NAME (Max. 40 chars):	
ALL DIMENSIONS ARE BEFORE TREATMENT UNLESS STATED	SURFACE TREATMENT: ---	DATE: ---	DATE: ---	Ø140mm (5.5") 3 PLATE C/CARBON CLUTCH INSTALLATION DRAWING	
FINISH: Ra	DATE: ---	DATE: ---	DATE: ---	PART NUMBER: KKC1403-STEP MASTER	
DATE: ---	DATE: ---	DATE: ---	DATE: ---	REV: A	
DATE: ---	DATE: ---	DATE: ---	DATE: ---	1 of 1	
DATE: ---	DATE: ---	DATE: ---	DATE: ---	A3	