

REVISION		
ISSUE	DATE	PARTICULARS
A	27.09.96	FIRST ISSUE
B	17.06.97	DIM W5 REDUCED BY 7
C	23.09.97	W1-W5 MODIFIED
D	16.12.99	PAD WAS 18 THK W1 & W2 INCREASED BY 1mm
E	17.06.04	N10: ADDED DIM PL 50.5 WAS 49.0
F	05.08.08	REFS 004 & H04 ADDED

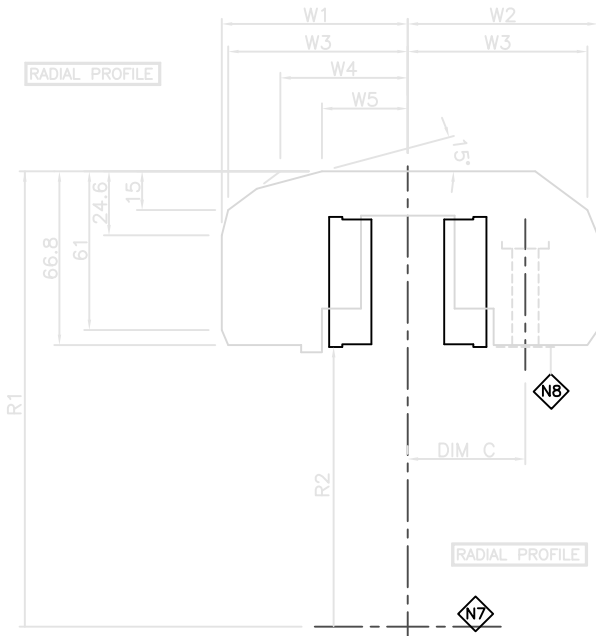

DISC Ø	R1	R2	R3
Ø315	175.0	107	134.3
Ø280	161.6	93	120
Ø254	151.8	80	107.4

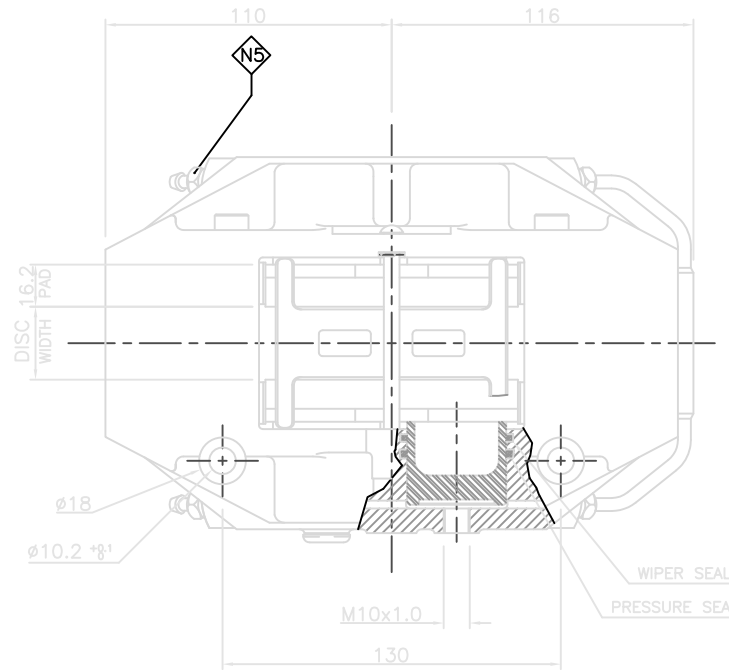

NOTES:

- N1: RIGHT HAND TRAILING CALIPER AS DRAWN
LEFT HAND TRAILING SYMMETRICALLY OPPOSITE
- N2: MANUFACTURING SPECIFICATION: RC2013
- N3: DISC ROTATION. DISC MUST PASS SMALL PISTON DIAMETER FIRST.
- N4: INSTALL CALIPER WITH PAD 0.8mm BELOW DISC
- N5: BLEED SCREW: - 14Nm HOT
- 18Nm COLD
- N6: ALL DIMENSIONS ARE NOMINAL
- N7: DISC AXIS
- N8: CALIPER MOUNTING FACE
- N9: PAD PROFILE
- N10: DIM H = ($\frac{\text{DISC DIA}}{2} - .08$) - DIM PL

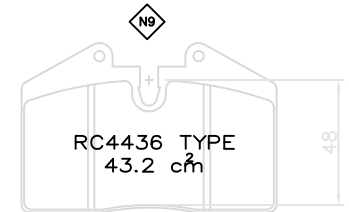
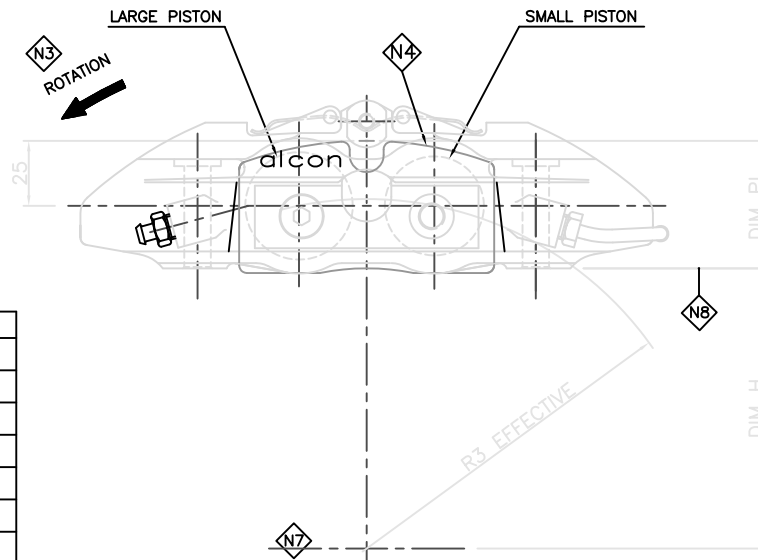

CALIPER PART No	RECOMMENDED DISC SIZE		Ø	WIDTH	DIM PL	DIM C	W1	W2	W3	W4	W5	REMARKS
	SMALL PISTON	LARGE PISTON										
CAR3650A01ASLT CAR3650A01ASRT	28.6	28.6	254	9.6/12.0	49.0	37.2	64.5	66.0	62.0	34.0	25.0	
CAR3657A01ASLT CAR3657A01ASRT	28.6	28.6	280	16.0/18.0	49.0	40.2	66.9	68.4	64.4	37.0	28.0	
CAR3653A01ASLT CAR3653A01ASRT	28.6	28.6	280	20.7/22.9	49.0	42.7	70.0	71.5	67.5	39.5	30.5	
CAR3654A01ASLT CAR3654A01ASRT	28.6	28.6	315	22.9/25.4	50.5	43.9	71.2	72.7	68.7	40.7	31.7	
CAR3654B01ASLT CAR3654B01ASRT	31.8	31.8	315	22.9/25.4	50.5	43.9	71.2	72.7	68.7	40.7	31.7	
CAR3654C04ASLT CAR3654C04ASRT	31.8	34.9	315	22.9/25.4	50.5	43.9	71.2	72.7	68.7	40.7	31.7	
CAR3654H04ASLT CAR3654H04ASRT	38.1	41.3	315	22.9/25.4	50.5	43.9	71.2	72.7	68.7	40.7	31.7	
CAR3656H01ASLT CAR3656H01ASRT	38.1	41.3	315	25.4/28.0	49.0	45.2	72.5	74.0	70.0	42.0	33.0	

© 2000 Alcon Components Ltd Tamworth England
THIS DOCUMENT IS CONFIDENTIAL AND THE DOCUMENT AND THE COPYRIGHT THEREIN ARE THE PROPERTY OF ALCON LTD. THE DOCUMENT AND ANY INFORMATION THEREIN MAY NOT BE USED, COPIED OR DISCLOSED TO ANY THIRD PARTY WITHOUT THE PRIOR WRITTEN AUTHORIZATION OF ALCON COMPONENTS LTD.

DRAWN GRR DATE 23.09.96
APPROVED PJS SCALE 1:1

TITLE CALIPER INSTALLATION
RADIAL MOUNTING
ROAD CAR CALIPER

DRG No. CAR36i01