

DO NOT SCALE  
IF IN DOUBT ASK

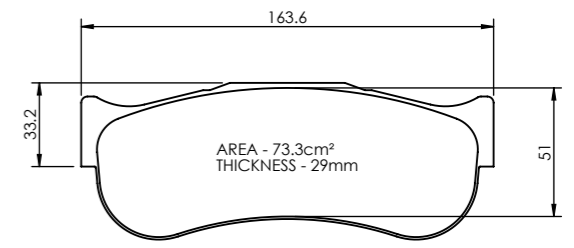
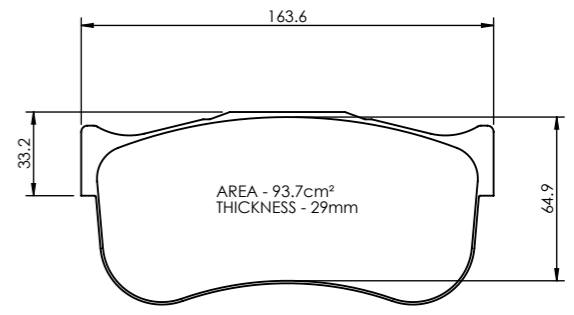
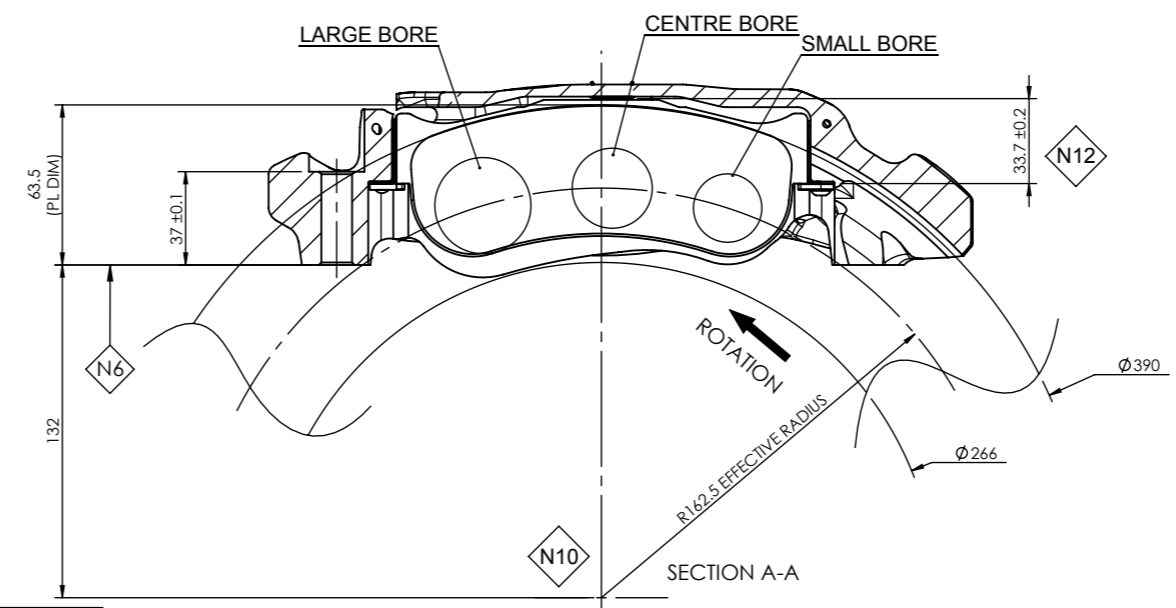
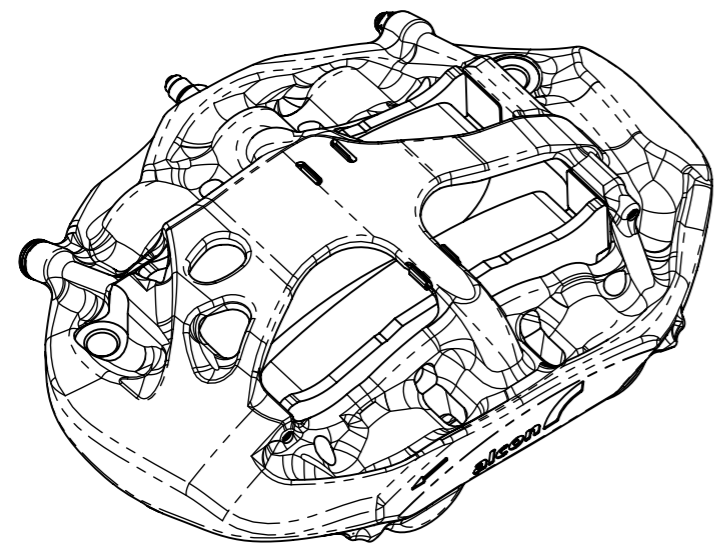
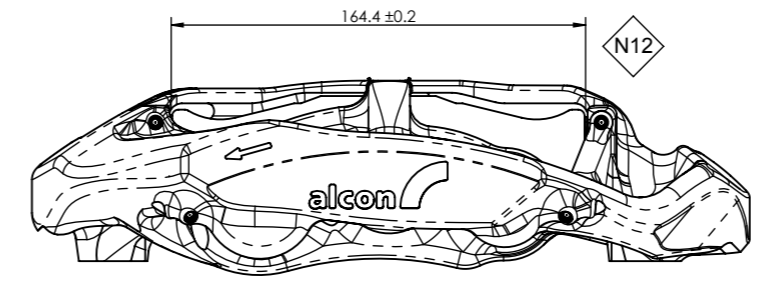
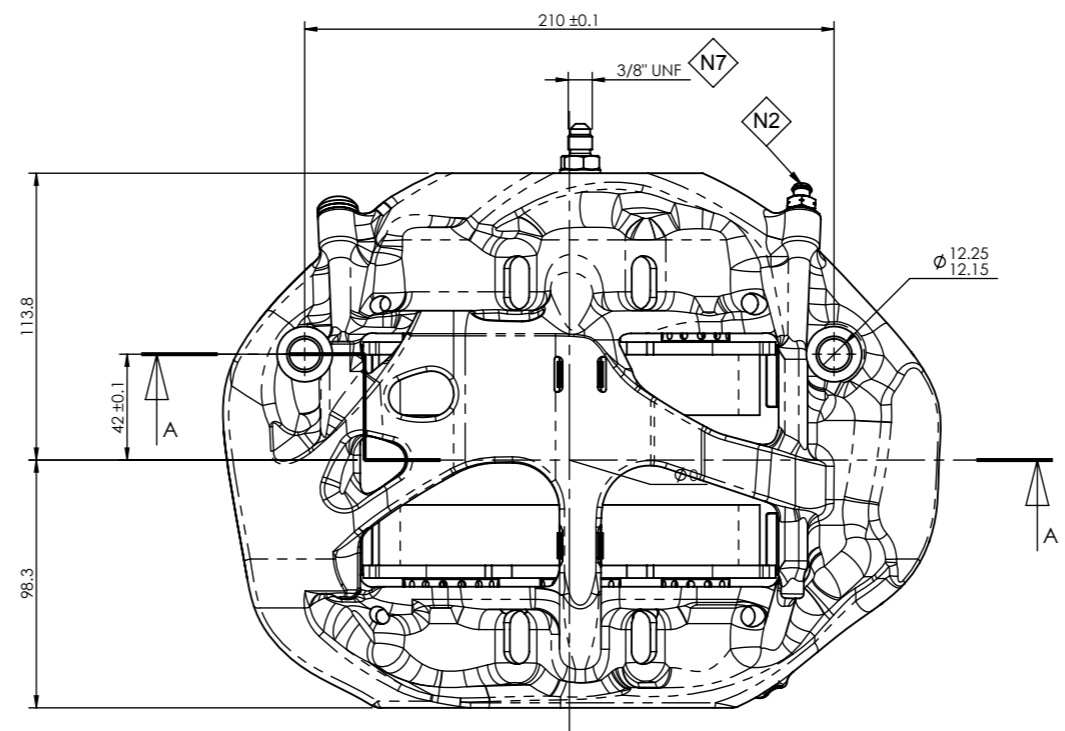
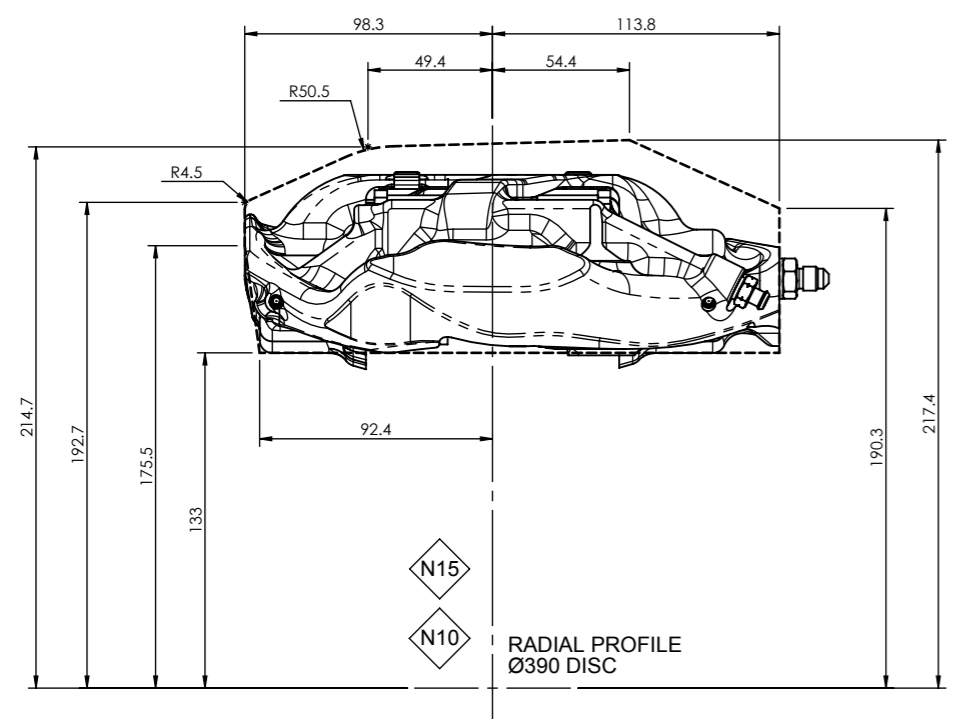

NOTES:

- N1: LEFT HAND LEADING CALIPER AS DRAWN  
LEFT HAND TRAILING CALIPER DIFFERS BY BLEED SCREW LOCATION  
RIGHT HAND LEADING CALIPER SYMMETRICALLY OPPOSITE  
RIGHT HAND TRAILING CALIPER SYMMETRICALLY OPPOSITE WITH BLEED SCREW AT LARGE BORE END.
- N2: BLEED SCREW: 3/8"-24 UNF, MAXIMUM TORQUE: 14Nm HOT  
18Nm COLD
- N3: INSTALL CALIPER WITH PAD 0.5mm ABOVE O.D. OF DISC & A MINIMUM CLEARANCE BETWEEN DISC & CALIPER OF 2.5mm
- N4: ALL DIMENSIONS ARE NOMINAL UNLESS OTHERWISE STATED
- N5: TOTAL CALIPER PISTON AREA: 50.13cm²
- N6: CALIPER MOUNTING FACE
- N7: FLUID INLET
- N8: CALIPERS SUPPLIED LESS PADS
- N9: DISC SIZES: IRON - Ø390 x 35.6mm  
CARBON - Ø390 x 37mm
- N10: DISC AXIS
- N11: ALL DIMENSIONS IN mm
- N12: DIMENSIONS FOR PAD FITMENT
- N13: CALIPER DESIGNED FOR USE WITH CONVENTIONAL 'O' RING SEAL 3/8"-24 UNF BLEED SCREW. DRY BREAKS CAN BE ORDERED SEPARATELY FROM ALCON, PART NUMBER FTQ4410X637.
- N14: CALIPER ASSEMBLY WEIGHT LESS PADS 2.8Kg
- N15: DUE TO COMPLEXITY OF CALIPER SHAPE, WHEEL CLEARANCE CHECKS SHOULD BE CARRIED OUT WITH 3D MODEL WHICH IS AVAILABLE ON REQUEST.

CAR9549Y76PESRT	RIGHT	TRAILING	Ø27.0 (5.7cm²)	Ø31.8 (7.9cm²)	Ø38.1 (11.4cm²)	
CAR9549Y76PESLT	LEFT	TRAILING	Ø27.0 (5.7cm²)	Ø31.8 (7.9cm²)	Ø38.1 (11.4cm²)	
CAR9549Y76PESRL	RIGHT	LEADING	Ø27.0 (5.7cm²)	Ø31.8 (7.9cm²)	Ø38.1 (11.4cm²)	
CAR9549Y76PESLL	LEFT	LEADING	Ø27.0 (5.7cm²)	Ø31.8 (7.9cm²)	Ø38.1 (11.4cm²)	
<b>Alcon Part No.</b>	<b>Hand</b>	<b>Orientation</b>	<b>Small Bore</b>	<b>Centre Bore</b>	<b>Large Bore</b>	<b>Remarks</b>

A FIRST ISSUE		IR 28.05.14	JH 28.05.14
Issue	Change	LOC	DRN BY / DATE
DRN BY / DATE	CHK BY / DATE	APP BY / DATE	
SCALE: 1:3	DRAWN BY: L. RATCLIFFE	DATE: 28.05.14	ALCON COMPONENTS LIMITED APOLLO TAIWORTH STAFFORDSHIRE B79 7TN TEL: +44(0)1827 723700
REMOVE ALL SHARP EDGES, BURRS AND SWarf	MATERIAL: VARIOUS - SEE PAGE 2	DATE: 28.05.14	NOTE: THIS DRAWING AND INFORMATION THEREUPON IS THE PROPERTY OF ALCON COMPONENTS LTD. IT IS LENT ON THE CONDITION THAT IT IN WHOLE OR IN PART, SHALL NOT BE REPRODUCED, COPIED, LENT OR DISCLOSED TO ANY PERSON WITHOUT WRITTEN CONSENT OF ALCON AND SHALL BE RETURNED TO ALCON COMPONENTS LTD.
ALL DIMENSIONS ARE BEFORE TREATMENT UNLESS STATED	HEAT TREATMENT: NONE	DATE: 28.05.14	PART NAME (Max. 40 chars): GT CALIPER
TOLERANCES UNLESS STATED: ±0.2 ANGLES: 80°	SURFACE TREATMENT: CALIPER HOUSING - ANODISED	DATE: 28.05.14	PART NUMBER: CAR95147
			REV. NO. / DATE: A / 1 of 2
			SIZE: A3

DO NOT SCALE  
IF IN DOUBT ASK

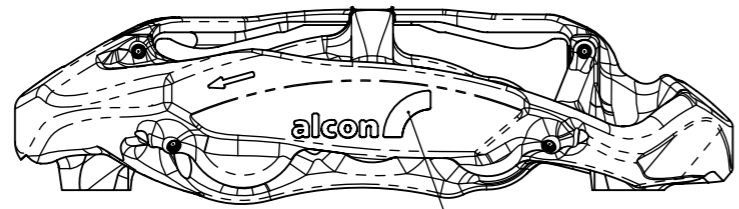

ALCON LOGO AND DIRECTIONAL ARROW TO BE FILLED WITH WHITE PAINT

LASER MARK ALCON PART NUMBER, DATE ASSEMBLED AND CUSTOMER PART NUMBER IF SPECIFIED ON JOB CARD, IN THIS AREA.

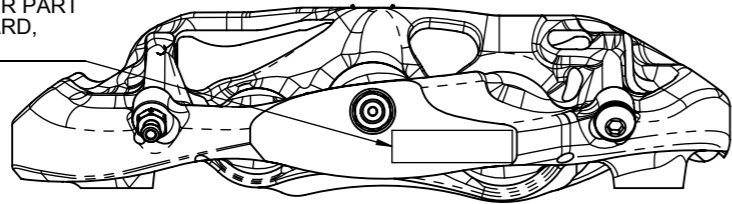

ITEM NO.	QTY.	PART NUMBER	DESCRIPTION	MATERIAL	NOTES
1	1	CAR95X1556L / R	CALIPER BODY	ALUMINIUM	
2	1	FSA3435X630	3/8" UNF FLUID INLET ADAPTOR	STEEL	19Nm±1 WITH LOCTITE 241
3	2	FCG0080X015	COPPER GASKET	COPPER	
4	1	BSB0080X005	3/8"-24 UNF BUTTON HEAD LOW PROFILE	STEEL	19Nm±1 WITH LOCTITE 241
5	1	FSB3430X689	BLEED SCREW 3/8"UNF ('O' RING TYPE)	STEEL	14Nm HOT - MAX 18Nm COLD - MAX
6	1	SER0080X176	0.280"x0.063" EPDM O-SEAL	'EP' RUBBER	
7	4	ASC4495X578	WEAR PLATE	STAINLESS STEEL	
8	1	PSC4495X579	UPPER WEAR PLATE	STAINLESS STEEL	
9	4	SSC4495X570	PAD SUPPORT	STAINLESS STEEL	
10	8	BSB0080X753	8-32UNC x 1/2" BUTTON HEAD SCREW	STEEL	2.3/2.7Nm WITH LOCTITE 241
11	2	PSV2739X250E	Ø27 STEEL PISTON	STAINLESS STEEL	
12	2	PSV3239X250E	Ø31.8 STEEL PISTON	STAINLESS STEEL	
13	2	PSV3839X250E	Ø38.1 STEEL PISTON	STAINLESS STEEL	
14	2	SES2700X751	Ø27 PISTON SEAL	'EP' RUBBER	KLÜBER UNISILKON TKM 1011
15	2	SES3200X751	Ø31.8 PISTON SEAL	'EP' RUBBER	KLÜBER UNISILKON TKM 1011
16	2	SES3800X751	Ø38.1 PISTON SEAL	'EP' RUBBER	KLÜBER UNISILKON TKM 1011
17	1	SSC3435X609	2Kg ANTI-KNOCKBACK SPRING	STAINLESS STEEL	LARGE PISTON
18	1	SSC3435X623	2Kg ANTI-KNOCKBACK SPRING	STAINLESS STEEL	MIDDLE PISTON
19	1	SSC3435X616	2Kg ANTI-KNOCKBACK SPRING	STAINLESS STEEL	SMALL PISTON
20	10	PSC0080X603	LEE PLUG 4.0 SHORT STAINLESS STEEL	STAINLESS STEEL	

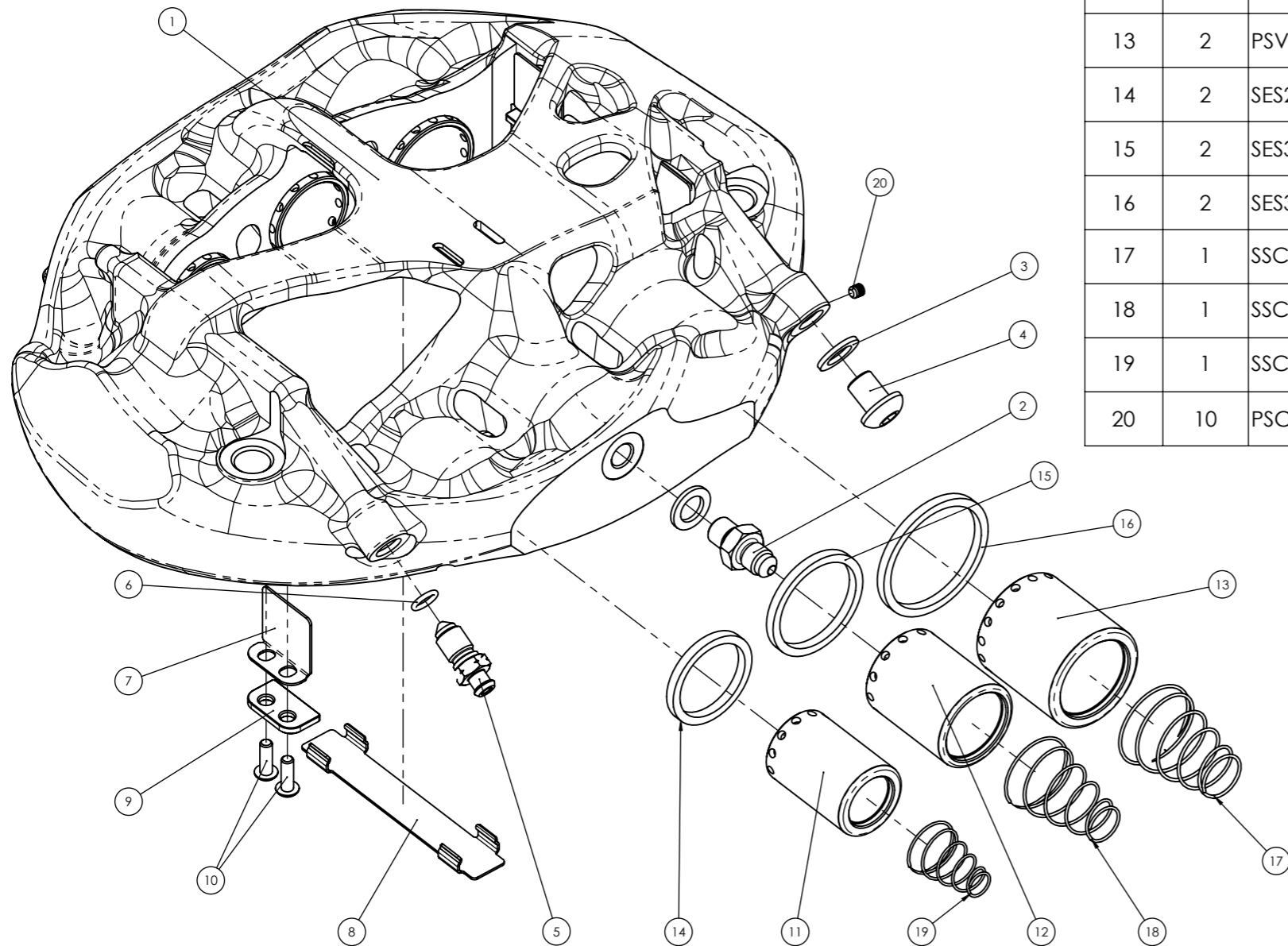

DRAWN IN SOLIDWORKS WEIGHT: SEE NOTES grams REMOVE ALL SHARP EDGES, BURRS AND SWarf FINISH: Ra (Ra) Ra ALL DIMENSIONS ARE BEFORE TREATMENT UNLESS STATED TOLERANCES UNLESS STATED: ±0.2 ANGLES: 80.9°	SCALE: 1:3 MATERIAL: VARIOUS - SEE PAGE 2 HEAT TREATMENT: NONE SURFACE TREATMENT: CALIPER HOUSING - ANODISED	DRAWN BY: L. RATCLIFFE DATE: 28.05.14 CHECKED BY: J. HUMBLE DATE: 28.05.14 APP'D BY:	ALCON COMPONENTS LIMITED APOLLO TOWN STAFFORDSHIRE B79 7TN TEL: +44(0)1827 723700 alcon engineering your advantage NOTE: THIS DRAWING AND INFORMATION THEREUPON IS THE PROPERTY OF ALCON COMPONENTS LTD. IT IS LENT ON THE CONDITION THAT IT IN WHOLE OR IN PART, SHALL NOT BE REPRODUCED, COPIED, LENT OR DISCLOSED TO ANY PERSON WITHOUT WRITTEN CONSENT OF ALCON AND SHALL BE RETURNED TO ALCON COMPONENTS LTD. PART NAME (Max. 40 chars): GT CALIPER PART NUMBER: CAR95I47 REV. NO.: A SHEETS: 2 of 2 SHEET NO.: A3
----------------------------------------------------------------------------------------------------------------------------------------------------------------------------------------------------------------------	-----------------------------------------------------------------------------------------------------------------------	--------------------------------------------------------------------------------------------------	----------------------------------------------------------------------------------------------------------------------------------------------------------------------------------------------------------------------------------------------------------------------------------------------------------------------------------------------------------------------------------------------------------------------------------------------------------------------------------------------------------------------------------------------------------